

Boston Data Center

Data Center Services Delivered

Data Centers

- 1 Four 500kVA Powerware UPS Systems
- 2 450 Tons of N+1 Redundant Cooling
- 3 Three 2.2 Mega Watt Caterpillar Diesel Generators
- 4 24x7x365 monitoring
- 5 38,000 sq. ft. total space

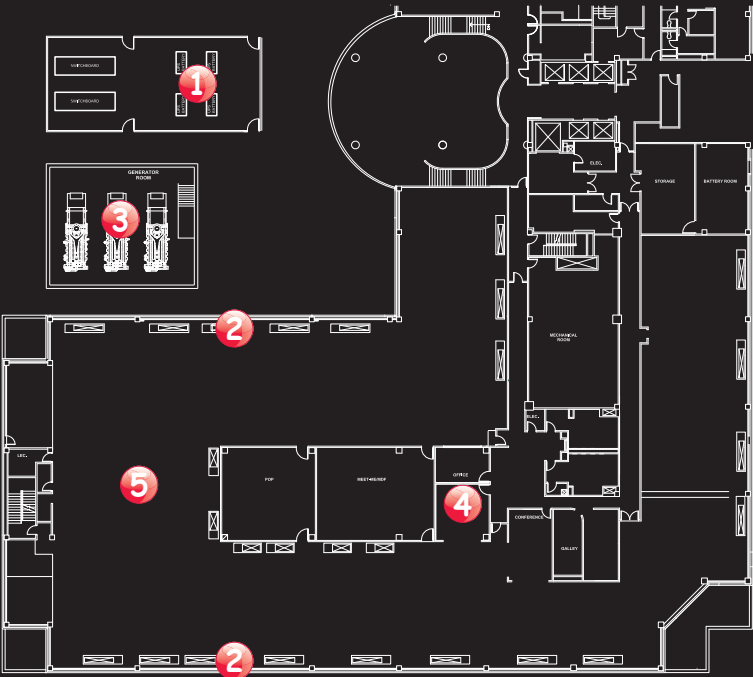

• **Advantages**

- Enterprise grade facility, without enterprise type capital investment
- Scalable Infrastructure - pay as you grow
- Flexibility to customize client solution based on needs assessment
- Strategically located in risk-averse region

Build vs. Buy...The value of outsourcing a data center rather than building your own

Benefits of Outsourcing: Reduce Your Deployment Costs, Increase Your Availability, Focus Your Staff, Speed Up Your Implementations and Provide Your Company With More Flexibility

Take advantage of an Expedient Data Center and enable your internal experts to focus on your company's business specific applications and rest easy knowing that your data is housed in an enterprise class facility that is being monitored and protected by a team of data center experts. Your company will enjoy all of the benefits of being in a top tier facility without taking on the financial burden of architecting, designing, building and maintaining your own data center. In addition you will have access to Expedient staff who are onsite 24x7x365 to act as remote hands to reduce the number of times that your own staff has to be dispatched after hours. An Expedient data center will act as the foundation for your technical infrastructure, which will free up more CAPEX for IT projects aligned with your core business requirements.

About Expedient

Expedient is part of a network of nationwide data centers which offer a wide range of managed services and network connectivity. These proven managed services combined with reliable and redundant SAS 70 Type II Certified and PCI-DSS compliant data centers, interconnected with a private 10Gbps network, enables Expedient to deliver premier colocation, network and managed services to enterprise, commercial, education and government entities.

Always Staffed Facilities

Expedient operates a 38,000 sq. ft. facility just 5 miles from Boston's financial district. Expedient employees staff this facility 24 hours a day, 7 days a week, 365 days a year. Operations Support Center staff are just 5 steps from the data center floor for remote hands work. Specialized, experienced, and certified engineers are available for consultation. The level of on-staff technical expertise is unparalleled in the region for a data center service provider.

Technical Specifications

Expedient maintains complete authoritative and operational control over this data center facility, working with staff facility engineers, electricians, and contractors to produce the solutions that custom fit clients needs.

Primary and Backup Power

- Dual 4000 Amp Power feeds
- 30,000 gallons diesel reserve

Security

- 24x7 Onsite security guard
- Digi-eye security cameras with motion detection and recording
- Security system with card entry

HVAC

- 28 Airflow Computer Room Air Conditioning units providing over 450 tons of cooling with four 12 fan dry coolers in an N+1 configuration

Fire Detection and Control

- Viking 3-stage fire suppression system
- Very Early Smoke Detection Apparatus (VESDA) in 14 zones

The Boston regions premier business class data center.

Regionally Diverse Carrier Capacity

Access to 8 Major Carriers including

- Expedient
- AT&T
- Verizon
- Verizon Business (MCI/Worldcom)
- Lighttower Dark Fiber
- Cogent Communications (Gigabit Ethernet)
- Verocity
- RCN Metro

Available Services

- Virtual/Cloud Hosting
- 'Virtual Data Center' Services
- Colocation
- Business Continuity
- Managed Secure Backup
- Managed Network Services
- Managed System Services
- Monitoring

Data Center Locations:

- Baltimore
- Columbus
- Boston
- Indianapolis
- Cleveland (x2)
- Pittsburgh (x2)

